

Please read this manual carefully before using this product and store it properly.

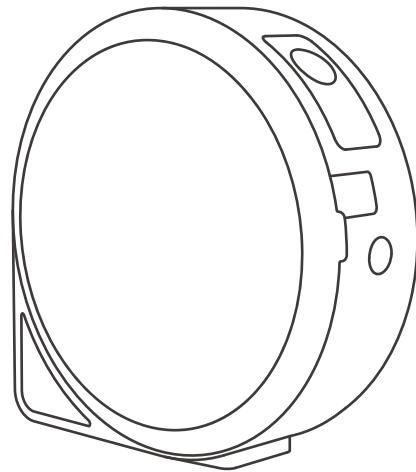

# User Manual

## Product Description

English

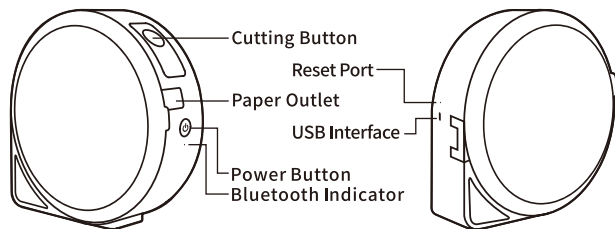

### Power indicator status

Indicator light color		Status	Solution
Power light	Orange light flash slowly	1. No printer ribbon 2. Press the cutting button when the printer is printing 3. Battery is lower than 10%	1. Press the cutting button again to cut the ribbon and print text again 2. Please use the cutting button to cut the printer ribbon and print again 3. Please connect the power source
	Orange light flash quickly	Power is lower than 5%, so can't print.	Connect to power source
	Orange light smooth dimming from 0%-100%	Charing, power was lower than 60%	/
	Blue light smooth dimming from 0%-100%	Charing, power was higher than 60%	/
	Blue light always on	Full charge	/
Bluetooth light	Blue light on	USB or Bluetooth connected	/
	Blue light flash slowly	USB or Bluetooth not connected	Please connect usb or bluetooth

## Operation Guidance

English

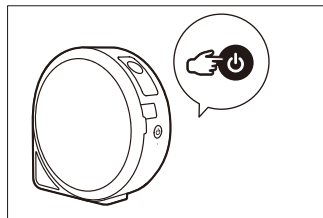

1. Fully charge the battery before using the first time. To turn on the machine, press and hold the power button for 3 seconds

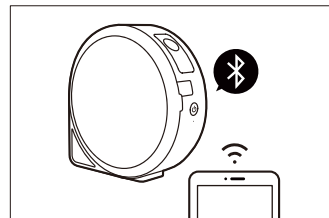

2. To turn on bluetooth, search for the device on the app and select device

Search for Print master and download the App



### Switch print ribbon

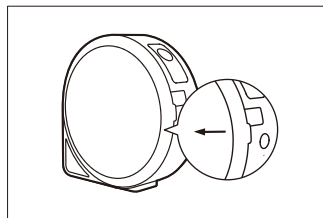

1. Open the side cover outwards in the direction of the arrow (see above)

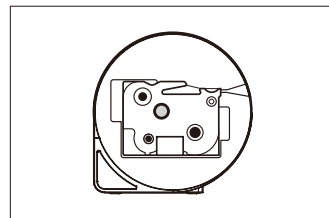

2. Insert the label tape cassette correctly as shown in the picture above. Close the cover to complete the installation.

- ① Insert or pull out the charge cable gently to avoid any damages to the port.
- ② Pull out the cable after charging is complete.
- ③ Do not charge or use the printer in high temperature, high humidity, or foggy circumstances (e.g. in a bathroom, a steam room or beside a fire) which may be dangerous. (NOTE: This machine is not suitable for tropical environments)
- ④ **Improper charging methods may cause damage.**
- ⑤ Do not touch the print head; it may hot.
- ⑥ Be aware of the sharp blade.
- ⑦ If the machine is malfunctioning, the reset hole can be used to restart the machine.

## Note

This equipment has been tested and found to comply within the limits of a Class B digital device, pursuant to Part 1 of the FCC Rules. These limits are designed to provide reasonable protection against harmful interference in a residential installation. This equipment generates uses and can radiate radio frequency energy and, if not installed and used in accordance with the instructions, may cause harmful interference to radio communications. However, there is no guarantee that interference will not occur in a particular installation. If this equipment does cause harmful interference to radio or television reception, which can be determined by turning the equipment off and on, the user is encouraged to try to correct the interference by one or more of the following measures:

- Reorient or relocate the receiving antenna.
- Increase the separation between the equipment and receiver.
- Connect the equipment into an outlet on a circuit different from that to which the receiver is connected.
- Consult the dealer or an experienced radio/T technician for help.

- Never disassemble, strike, squeeze or put into fire;
- If there is severe swelling, do not continue to use;
- Do not put in a high temperature environment. Do not use if immersed in water;
- Be sure to replace with an appropriate type of battery. (There is danger of explosion if you replace it with the wrong type of battery.)
- Be sure to dispose of the used battery as instructed.

## FCC Caution

- Changes or modifications not expressly approved by the party responsible for compliance could void the user's authority to operate the equipment.
- This equipment has been tested and found to comply with the limits for a Class B digital device, pursuant to Part 15 of the FCC Rules. These limits are designed to provide reasonable protection against harmful interference in a residential installation. This equipment generates uses and can radiate radio frequency energy and, if not installed and used in accordance with the instructions, may cause harmful interference to radio communications. However, there is no guarantee that interference will not occur in a particular installation. If this equipment does cause harmful interference to radio or television reception, which can be determined by turning the equipment off and on, the user is encouraged to try to correct the interference by one or more of the following measures:
- Reorient or relocate the receiving antenna.
  - Increase the separation between the equipment and receiver.
  - Connect the equipment into an outlet on a circuit different from that to which the receiver is connected.
  - Consult the dealer or an experienced radio/TV technician for help
- This device complies with part 15 of the FCC rules. Operation is subject to the following two conditions (1) this device may not cause harmful interference, and (2) this device must accept any interference received, including interference that may cause undesired operation.

## Product Warranty Description

English

Thank you for choosing Print master.

1. The free warranty period is 1 year from the date of purchase.
2. Within 30 days from the date of receipt, the user can choose to return the item.

Please save the warranty/maintenance card properly. The warranty/maintenance card will not be replaced if lost or damaged.

## Non-warranty regulations

The warranty is void under the following conditions:

- ① Exceeding the warranty period.
- ② Not presenting the original warranty/maintenance card.
- ③ Presenting a damaged warranty/maintenance card (e.g. torn or tampered with) Altering product information.
- ④ Damage caused by unauthorized repair, disassembling, etc.
- ⑤ Damage caused by human error.
- ⑥ Damage caused by natural disasters such as earthquakes, floods, windstorms, lightning strikes, or external disasters such as fires and home collapses.
- ⑦ Failure or damage caused by harsh conditions (oil, dust, moisture, direct sunlight, etc.) or failure to use or care for as required by the instruction manual.

## Warranty/Maintenance Card

English

☐

Replace

☐

Return

☐

Repair

User Info	Name:	Gender:	Phone:
	Address:		
Product information	Date of purchase:		
	Product Order Number:		
	Product Serial Number:		
Return , Replace, or Repair Request	Reasons:		
Maintenance records	Fault conditions:		Maintenance staff:
	Processing situation:		Repair date:
	Repair ticket number:		Date of inspection:

## Product certification

Inspector:

Date of manufacture:

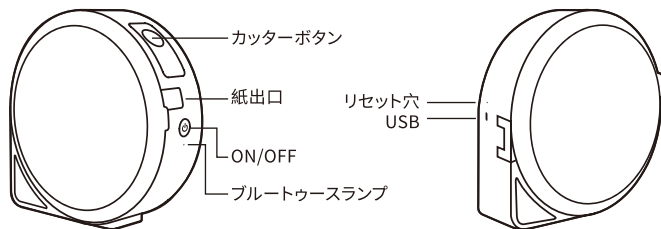

指示灯情報		状態	原因/解決方法
電池ランプ	オレンジ色長く点滅	1. インクリボン未装着 2. 印刷時にカッターボタンを押した 3. 電池残量が10%以下となった	1. 再装着ください 2. 再度印刷ください 3. 電源へつなげて充電してください
	オレンジ色短く点滅	電池残量が5%以下、印刷不可	電源に接続ください
	オレンジ色呼吸ランプ	充電中、電池残量60%以下	/
	青い呼吸ランプ	充電中、電池残量60%以上	/
	青いランプ点灯	電池残量FULL	/
ブルートゥースランプ	青いランプ点灯	USBやブルートゥースに接続済み	/
	青いランプ長く点滅	設備に接続していない	USBやブルートゥースに接続してください

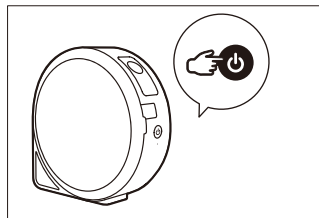

1. 初めてご使用の場合、充電してから、長く電源ボタンを三秒押してONにします

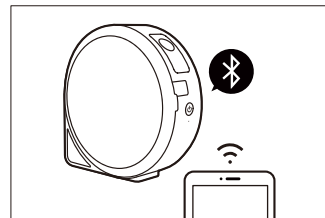

2. ブルートゥースをONに、Appにて設備を検索 & 接続してから、印刷をスタートしてください!

Print masterを検索し、下記のAppをDownloadしてください



## インクリボンの交換

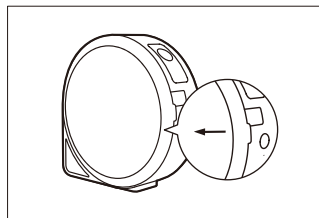

1. 矢印方向で、外へ向けてキャップを開けてください

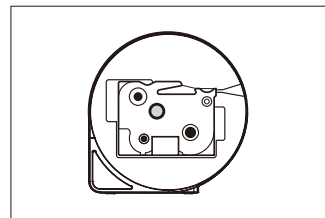

2. 指示図通りに消耗材を正しくセットしてから、キャップを閉めてください

- ① 充電端子に損害を及ぼさないように、充電ケーブルを軽く扱ってください
- ② 充電完了後、充電ケーブルを抜き出してください
- ③ 危険を防ぐために、高温、高湿度、煙や霧の多い場所や埃環境でのご使用や充電をしないでください。例えば：シャワー室、サウナ室、火気など
- ④ 不当な充電ではプリンタービットに損害を与えるので、十分注意してください
- ⑤ 焼けなど起こさないように、プリンタービットを触らないでください
- ⑥ カッターを触らないようにしてください
- ⑦ 設備故障の場合、リセット穴を挿して、改めて設備を再起動できます

## 電池警告説明

- ① 禁止拆解、撞击、挤压或投入火中；
- ② 分解、衝突、重压又は火に投入のが厳禁；
- ③ 若出现严重膨胀，请勿继续使用；
- ④ 著しく膨らみが起こった場合は、使用しないでください；
- ⑤ 请勿置于高温环境中，电池浸水后禁止使用；
- ⑥ 高温環境に放置しないでください。電池が水に接触した後に使用しないでください；

注意！不当な電池交換による爆発きけんがありますので、同様仕様の電池しか交換しないでください。

本商品のアフターサービスは「中華人民共和国消費者權益保護法」、「中華人民共和国商品品質法」に基づき、アフターサービスを提供しております。内容は下記のとおりです：

1. 本商品の無料修理期間：購入された日から1年間（正式購買領収書の日付を準にする）。
2. ユーザーが受け取った翌日から7日間以内に、返品や交換や無料修理を選ぶことができます。受け取った日から8～15日間以内に、交換や無料修理を選ぶことができます。
3. 無料修理は保険、郵送、運送などの費用は含まなく、お宅までのサービスもございません。修理用カードが紛失した場合は改めての発行はできませんので、どうぞ貴重に御扱いください。

## 非修理サービス条例（下記の場合では有償といたします）

- ① 修理有効期限オーバーの場合
- ② 同時に購買領収書と修理カードのオリジナルを提供できない、又は修理カードと領収書の情報が合わない場合。
- ③ 悪意に修理カードの内容、商品情報を模糊破壊、破く、改窜するなど含む損害する行為があった場合。
- ④ 無断に修理、分解などによる損害があった場合。
- ⑤ 人為的な原因での損害があった場合。
- ⑥ 地震、水災、風災、雷など自然災害又は、火災、建屋崩壊などでの外部災害による損害があった場合。
- ⑦ 劣悪な環境（油煙、土埃、直射日光等）でのご使用、又は、取扱説明書通りにされなく、故障や損害を起こした場合。

# 修理카드

日本語

☐ 교환 ☐返品 ☐修理

ユーザー情報	氏名:	性別:	電話番号:
	住所:		
商品情報	購買日付:		
	商品オーダーNo.:		
	商品シリアルNo.:		
返品や交換の記録	返品や交換の理由:		
修理記録	故障状況:	修理担当:	
	処理状況:	受入日:	
	修理伝票No.:	修理完成日:	

## 商品合格証

検査員:

出荷日:

# 제품소개

한국어

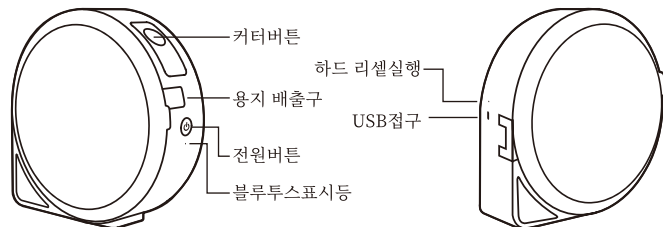

표시등정보		상태	원인/해결책
전기량 표시등	오렌지색으로 느리게 번쩍이다	1. 타자용리본 미 장착 2. 인쇄할 때 커터버튼을 눌렀다 3. 배터리10%미만	1. 타자용리본 장착 2. 다시 인쇄 3. 충전
	오렌지색으로 빠르게 번쩍이다	배터리5%미만, 인쇄불가능	전원 연결
	오렌지색으로 브리딩램프	충전중, 배터리60%미만	/
	파랑색으로 브리딩램프	충전중, 배터리60%이상	/
	파랑색으로 항상 켜져있다	충전완료	/
블루투스 표시등	파랑색으로 항상 켜져있다	USB혹은블루투스 연결성공	/
	파랑색으로 느리게 번쩍이다	연결되지 않았음	USB혹은 블루투스를 연결하 세요に接続してください

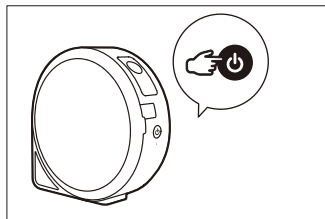

1. 처음 사용시 먼저 충전하고 전원단추를 3초 동안 길게 눌러주세요

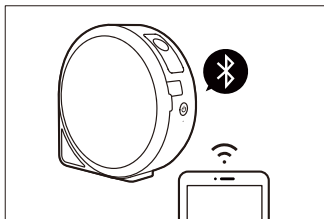

2. 블루투스를 켜고 App에서 장치를 검색하고 연결하여 인쇄를 시작합니다!

Print master App를 검색해  
다운로드해주세요



## 타자용리본을 교체하기

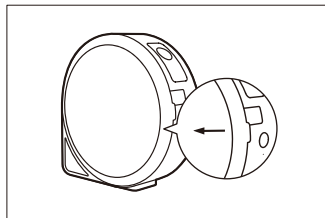

1. 화살표 방향으로 상단 커버를 바깥쪽으로 엽니다.

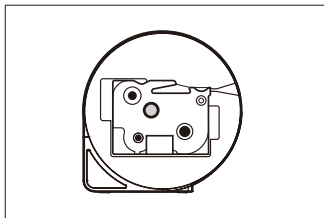

2. 지시된 그림 방향으로 소모품을 올바르게 넣고 상단커버를 다시 덮고 설치를 완료합니다.

- ① 충전 포트에 손상을 주지 않도록 충전선을 살짝 삽입하거나 당기지 마
- ② 충전이 완료되면 충전선을 빼주세요
- ③ 위험을 피하기 위해 욕실, 찜질방, 화염부근과 같은 고온고습, 과도한 연기와 먼지가 있는 환경에서 사용하거나 충전하지 마십시오.
- ④ 부적절한 충전으로 인해 프린트 헤드가 손상될 수 있습니다.
- ⑤ 과열로 인한 화상을 방지하기 위해 프린트 헤드를 만지지 마십시오.
- ⑥ 커터가 날카로우니 건드리지 않도록 조심하세요
- ⑦ 기계가 작동하지 않을 경우 리셋 구멍을 살짝 찌르면 시스템이 재부팅됩니다.

## 배터리 경고 설명

- ① 분해, 충격, 압출 또는 불속에 주입등은 금지되어 있습니다.
- ② 심각한 팽창이 발생하면 사용을 중지하십시오.
- ③ 고온 환경에 방치하지 마시고 배터리가 물에 잠긴 후에는 사용이 금지됩니다.

주의! 배터리를 잘못 교체하면 폭발위험이 있으므로 동일한 유형의 배터리로만 교체할 수 있습니다.



## 애프터세일 서비스 설명서

한국어

제품의 애프터서비스는 엄격하게 《중화인민공화국소비자 권익보호법》,《중화인민공화국 제품품질법》에 따라 애프터서비스 three commitments after sales service 서비스를 실시하며 서비스 내용은 다음과 같습니다.

- ① 본 제품의 무료 보증기간은 구매일로부터 1년(정식구매한 영수증날짜로 기준)입니다.
- ② 사용자가 서명한 날로부터 7일 이내에 사용자는 반품,교환 또는 무료 수리 서비스를 선택할 수 있습니다. 서명한 날로부터 8-15 일 이내에 사용자는 교환 또는 무료 수리 서비스를 선택할 수 있습니다.
- ③ 무료수리서비스에는 보험, 우편, 배송등의 잡비가 포함되지 않으며 현장 서비스가 제공되지 않습니다.

보증 카드를 타당하게 보관하십시오. 보증카드 분실시 재발급이 안됩니다.

### 애프터세일 서비스가 안되는 경우 (다음과 같은 경우 유료보수 서비스를 제공합니다)

- ① 보증 유효 기간 초과시
- ② 구매영수증과 본 보증카드 원본을 동시에 제시할 수 없거나 보증카드&영수증정도가 일치하지 않을시.
- ③ 악의적인 보증카드 내용,제품정보손상시,희미하게 파괴, 스스로 찢기,변조등 상황시.
- ④ 무단 수리, 사적인 분해 등으로 인한 손상.
- ⑤ 인위적인 이유로 손상.
- ⑥ 지진, 수해,풍해,번개등의 자연재해나 화재,주택붕괴와 같은 외부 재해로 인한 손상.
- ⑦ 약정한 조건 (유연,먼지,습기,직사양광 등)하에 사용하거나 사용설명서의 요구 사항에 따라 보관,사용, 유지보수하지 않아 발생하는 고장 및 손상.

## 보증카드

한국어

☐

반품

☐

교환

☐

수리

사용자정보	이름:	성별:	전화:
	주소:		
제품정보	구매일:		
	제품오더번호:		
	제품아이디:		
반품교환기록	반품교환이유:		
수리기록	고장정황:	수리자:	
	처리정황:	수리보낸날자:	
	수리원서번호:	검수날자:	

## 제품합격증

검사인:

출고날자: