

D30 Product Instruction

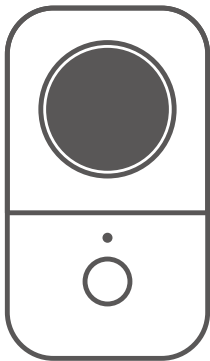

Please read this Instruction carefully
before using this product and keep it properly

01.Packaging List

- ① Printer*1

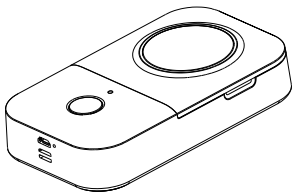

- ② Product Instruction*1



- ③ Data cable*1



02.Device Parameter

| | |
|----------------------------|--------------------------------------|
| Product Name | Small Label Printer |
| Product model | D30 |
| Printing technology | Thermal printing |
| Effective printing width | 12mm |
| Supported consumables | Thermal label paper/Black mark paper |
| Printing density | Light、standard、dark |
| Printing resolution | 203dpi |
| Print head service life | 50KM |
| Communication interface | Bluetooth4.0 |
| Product Size | 5.2*2.3*1.2in |
| Power Input | 5V~2A |
| Power Supply Method | Micro USB |
| | Lithium battery |
| Supported operating system | Android |
| | iOS |

03.Component instruction

1.Appearance Introduction

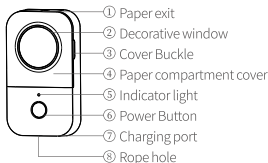

2.Functions of the power button

| Operation method | Functions |
|-------------------|---------------------|
| Press and hold 2S | Turn on/off |
| Click | Print out the paper |
| Double click | Print test page |

3.Power indicator status

| Indicator light | status | Description |
|-----------------|---------------|---|
| Green | Keep on | normal status (printing) |
| | Flash slowly | harging with power on |
| | Flash quickly | charging with power off |
| Red | Keep on | error (lack of paper, cover opened, high temperature) |
| | Flash slowly | 10% of battery remaining |
| | Flash quickly | 5% of battery remaining |

04. Introduction of paper roll installation

- ① Open the paper compartment cover

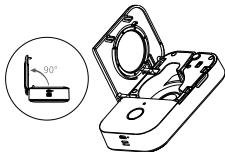

- ② Disassemble the label paper and put into the paper compartment

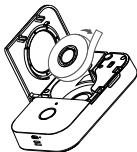

- ③ Please pull out the paper out of the paper outlet 5mm

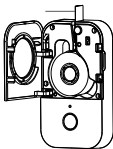

- ④ Close the paper compartment cover and connect with the App to use

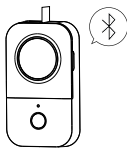

Search Print master on App Store or Google Play to Get the App



Google Play



App Store



Print master

05. Product warranty

Thank you for choosing the small label printer

- ① The free warranty period of this product is one year from the date of purchase (subject to the date of the official purchase invoice).
- ② Please keep the warranty card properly, which will not be reissued in case of loss
- ③ Please keep the warranty card properly, which will not be reissued in case of loss

06. Non-warranty Regulations

The warranty is void under the following conditions:

- ① Exceeding the warranty period.
- ② Not presenting the original warranty/maintenance card
- ③ Presenting a damaged warranty / maintenance card (e.g. tearing or tampering)
- ④ Damage caused by unauthorized repair, disassembling, etc.
- ⑤ Damage caused by human error .
- ⑥ Damage caused by natural disasters such as earthquakes, floods, windstorms, lightning strikes or external disasters such as fires and house collapses .
- ⑦ Failure or damage caused by harsh conditions (oil, moisture, direct sunlight etc.) or failure to use or care for as outlined by the instruction manual .

07. Warranty /MaintenanceCard

☐

Replace

☐

Return

☐

Repair

| | |
|--|--|
| User Information | Name: Gender: Phone: |
| | Address: |
| Product Information | Date of purchase: |
| | Product order number: |
| | Product serial number: |
| Reason for Return (Replace/ Repair/ Request Maintenance) | Fault description: |
| Maintenance Records: | Fault conditions: Maintenance staff: |
| | Processing situation: Repair date: |
| | Repair ticket number: Date of inspection: |